

Pianta coperture

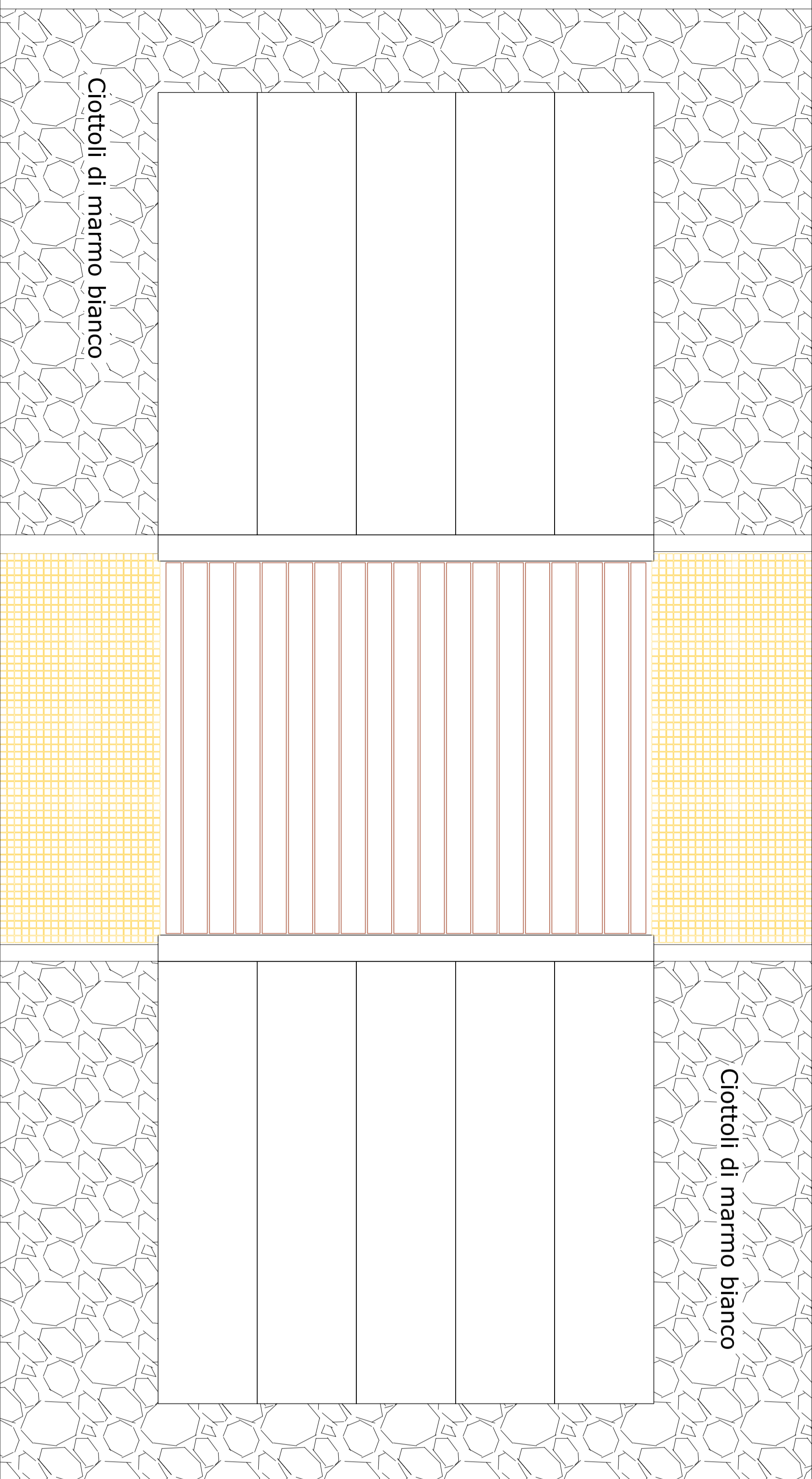

Materiali in uso

Rivestimento in lastre di Travertino romano chiaro non stuccato spessore cm. 3, comprese le lastre a chiusura dei loculi
 Borchie in bronzo tipo Savona
 Loculi prefabbricati
 Impalcato in tavole di

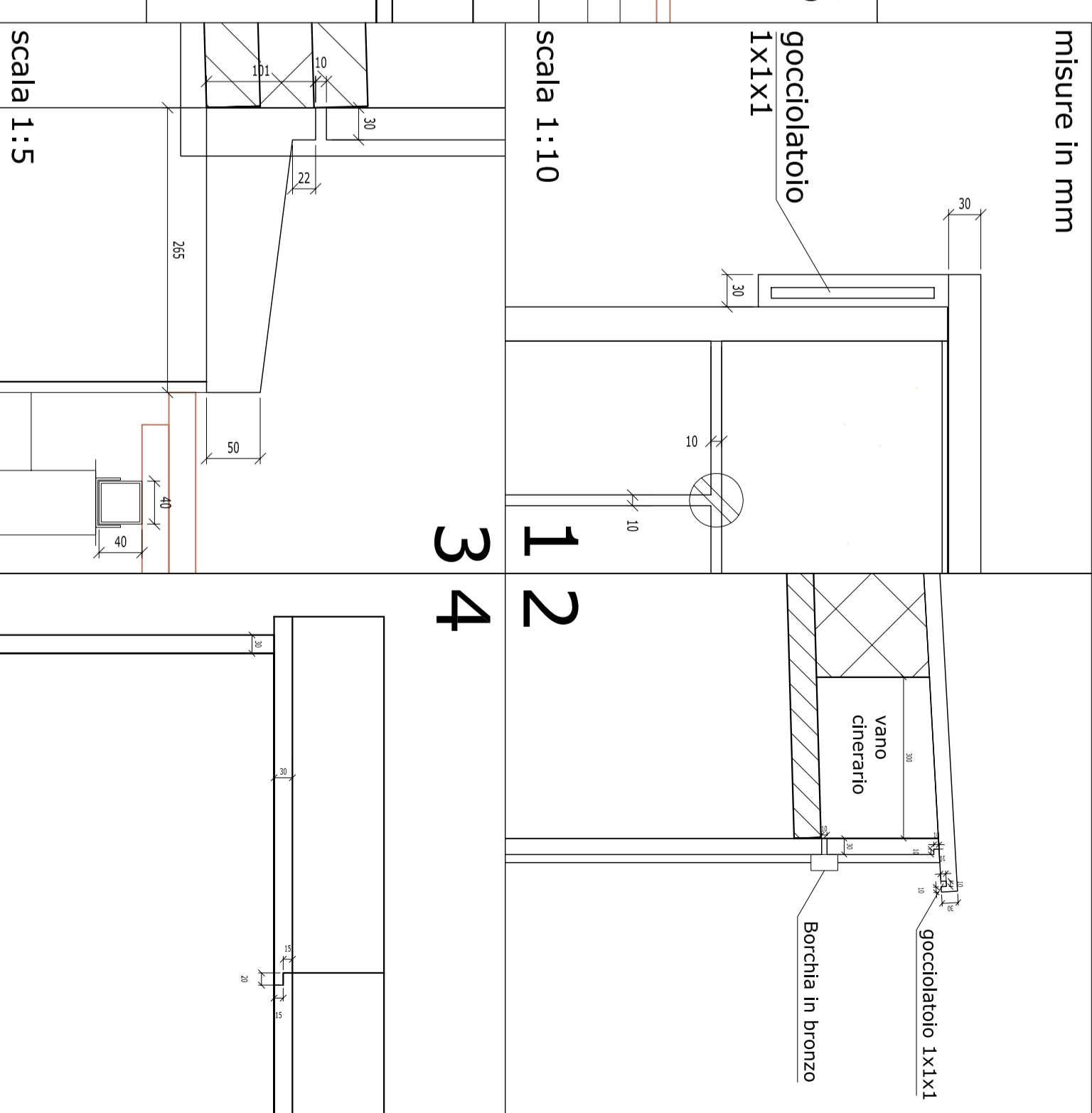
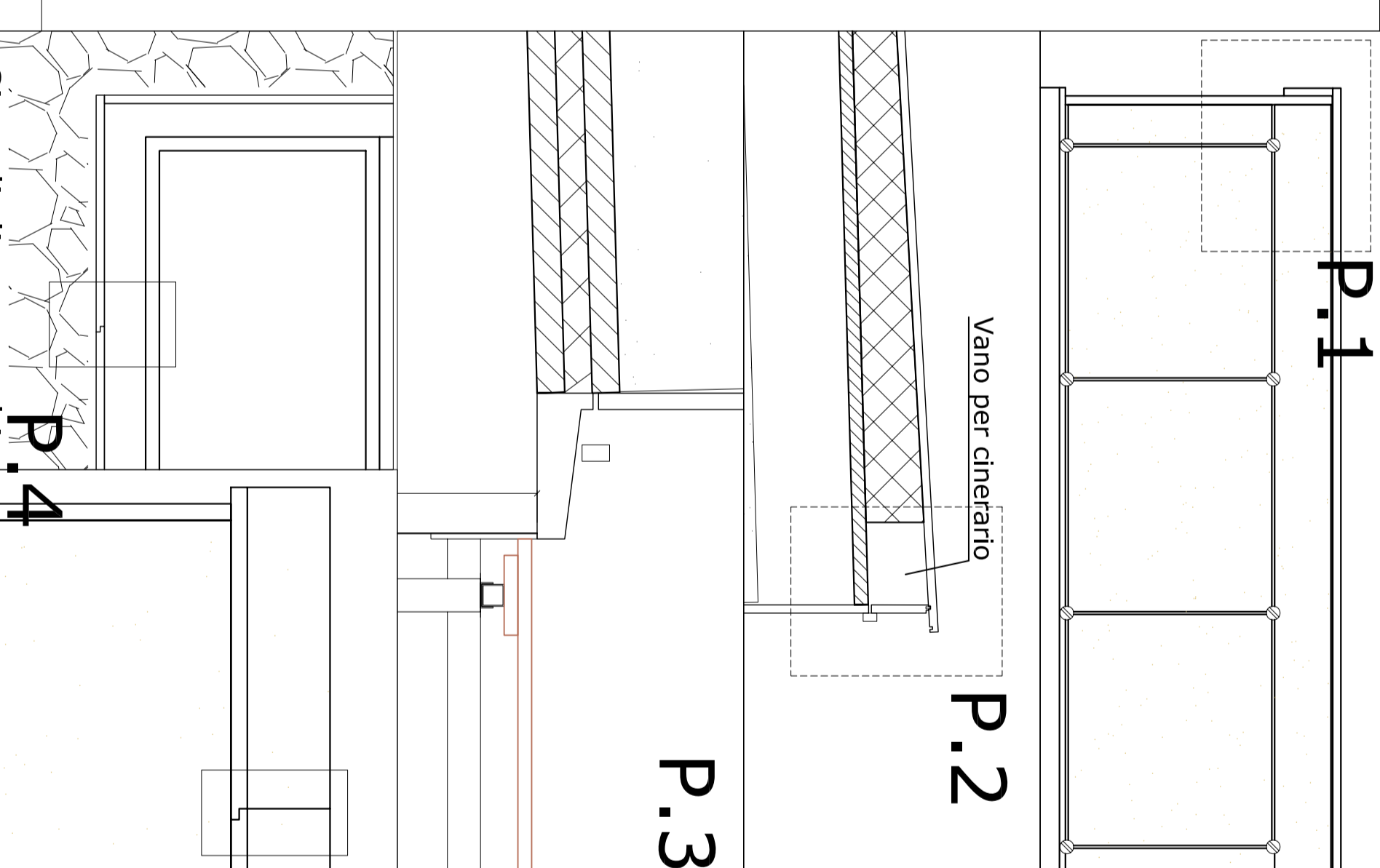

Filo esterno getto di sottofondazione

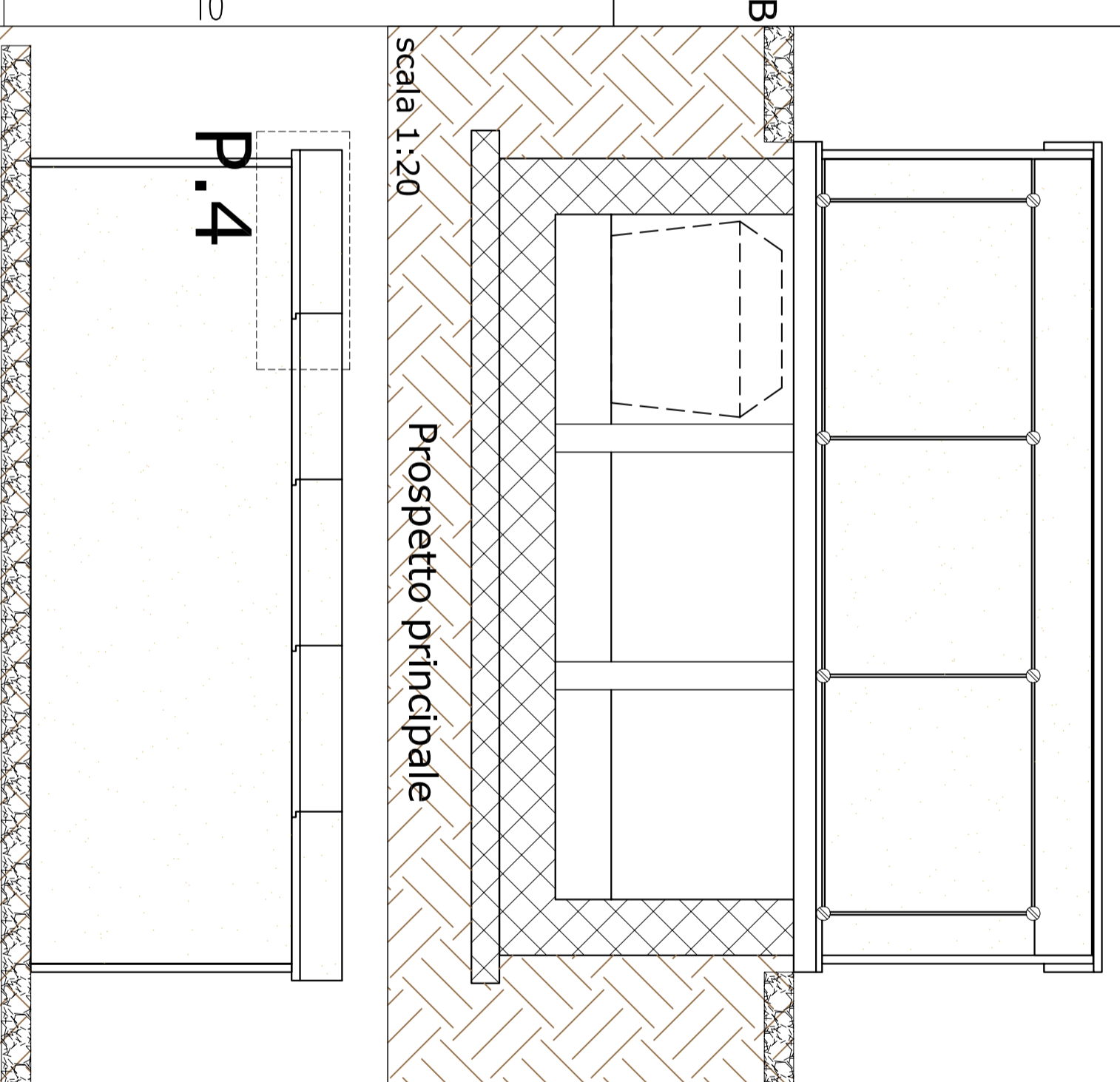
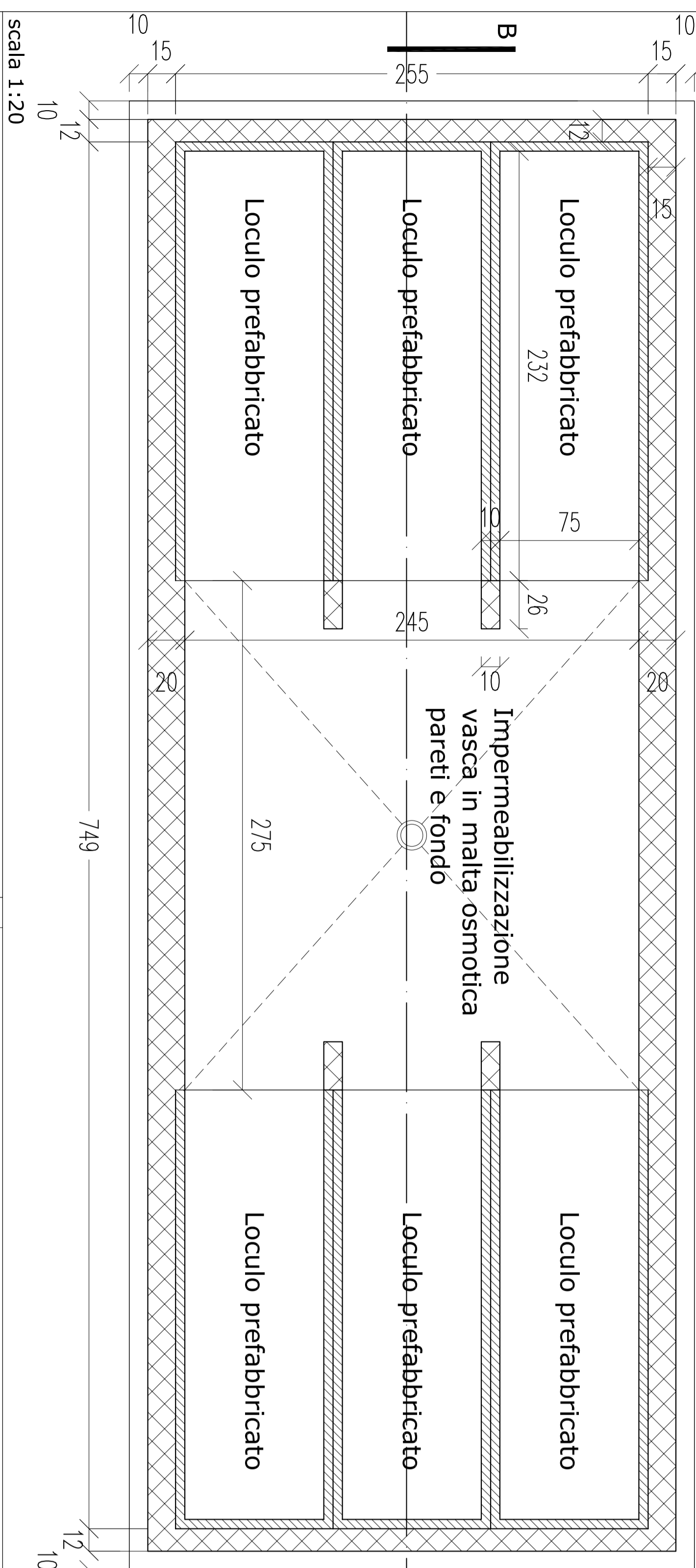

COMUNE DI SAVONA – CIMITERO DI ZINOLA
 – Sistemazione campi d'innaffiatura –
 – CAMPO "B" 2° stralcio

OGGETTO: Progetto Esecutivo Particolari Tombo Ipogea

Proprietà: Amministrazione Comunale di Savona

Progetto: dott. arch. Sergio CHIZZOLA
 via F.lli. Rodolfo 6/100056
 17100 – SAVONA – Tel. 019/660056

Titolo	Tavola n°
Frame	07
Scale	1:50 – 1:10
Collaboratori	Nome File

P.3

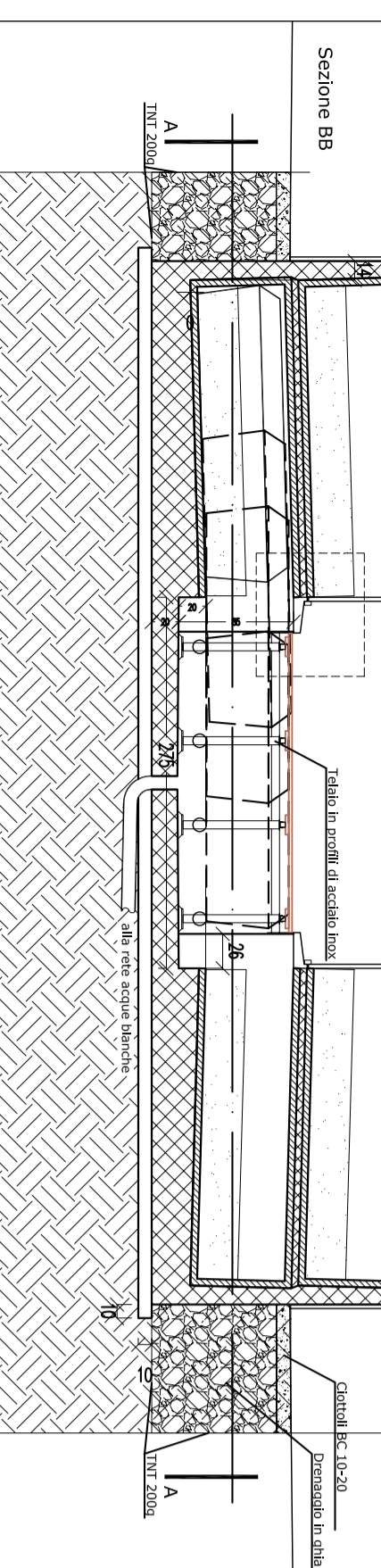

P.4

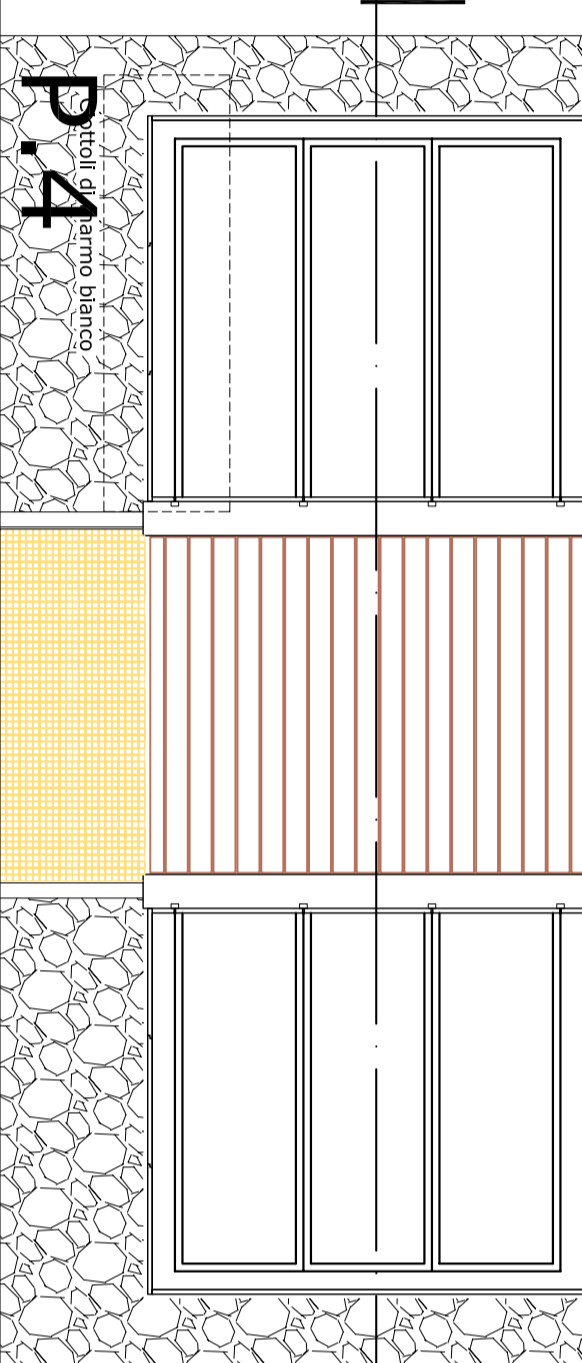

P.4



P.4



P.4



P.4

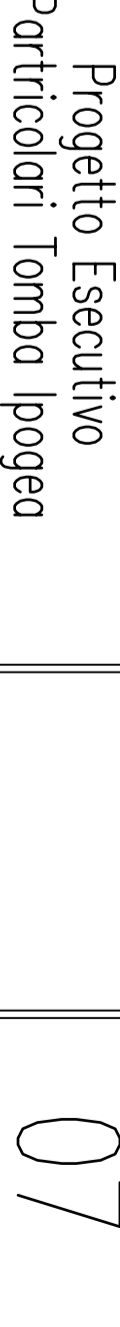

scala 1:50

scala 1:50

scala 1:20

scala 1:5

scala 1:50

scala 1:20

scala 1:20